

CITY OF GREENVILLE

“Danish Festival City”



411 SOUTH LAFAYETTE STREET
GREENVILLE, MICHIGAN 48838
(616) 754-5645 FAX (616) 754-6320

NOTICE TO BIDDERS

2017 Greenville Portage Walkway

The City of Greenville will receive sealed bids for preparing, forming, pumping and placing approximately 455 square feet of 4-inch thick concrete sidewalk; construction of an approximately 1.8 cubic yard reinforced concrete stairway in a dry area under the Franklin Street Bridge, and placing approximately 3.5 cubic yards of rip rap grout. The bids will be received until Tuesday, February 14, 2017 at 2:00 p.m., in the City Hall Conference Room. All bids will be publicly opened and read aloud at that time.

Specifications and information for bidders may be obtained at the City Clerk's Office at Greenville City Hall, 411 S. Lafayette, Greenville, Michigan 48838 or on-line at <http://greenvillemi.org/bids-rfps/>.

NORICE T. RASMUSSEN
Clerk-Treasurer

**SPECIFICATIONS
FOR
2017 Greenville Portage Walkway**

THE CITY OF GREENVILLE WILL RECEIVE SEALED BIDS FOR PREPARING, FORMING, PUMPING AND PLACING APPROXIMATELY 455 SQUARE FEET OF 4-INCH THICK CONCRETE SIDEWALK; CONSTRUCTION OF AN APPROXIMATELY 1.8 CUBIC YARD REINFORCED CONCRETE STAIRWAY IN A DRY AREA UNDER THE FRANKLIN STREET BRIDGE, AND PLACING APPROXIMATELY 3.5 CUBIC YARDS OF RIP RAP GROUT. THE BIDS WILL BE RECEIVED UNTIL TUESDAY, FEBRUARY 14, 2017 AT 2:00 P.M., IN THE CITY HALL CONFERENCE ROOM. ALL BIDS WILL BE PUBLICLY OPENED AND READ ALOUD AT THAT TIME.

INSTRUCTIONS TO BIDDERS

SCOPE OF WORK: This Project will require coordination with the City of Greenville Public Services Department and involves the preparation, forming and placement of a concrete stairway and walkway to be used as a portage around the Franklin Street Dam, which is located near the Flat River Museum at 213 N. Franklin Street. The walkway will pass beneath the Franklin Street Bridge so concrete and grout will need to be delivered by pumping.

The Greenville Department of Public Services will relocate rip rap in the proposed walkway area as shown on the Plan and add more rip rap as necessary prior to the Contractors Work leaving a space to set forms on the River side of the walk. The City will also make sand available for preparation work.

The Contractor will place forms for the 6-foot wide walkway at a consistent slope as near to existing grade as possible with a maximum cross-slope of ¼ inch per foot, and the stairway. Once formed, the Contractor shall place sand fill as necessary to provide for a 4-inch thickness of walkway. Limited excavation is anticipated. Forms on the rip rap side will be left in place. The Contractor shall place expansion joint material along the bridge side of the walkway for the entire length of the abutment wall and move rip rap as necessary to fill in the work area along the edge of the placed form.

The City of Greenville will provide traffic control for the grout and concrete pours. The Contractor shall arrange for pumping grout and concrete as a continuous operation.

BIDDER'S INVESTIGATION: Prior to submission of the bid, all bidders shall make, and shall be deemed to have made a careful examination of the site (shown on the enclosed maps), the Scope of Work, the specifications included herewith, and shall have become informed as to the location and nature of the proposed work, general existing conditions, and all other matters that may affect the cost and the time of completion of the contract.

WORKMANSHIP: All construction shall be completed in a first-class workmanlike manner. The City will perform full-time inspection of the site, and the contractor will guarantee all materials and workmanship for a period of one (2) year from the date of substantial completion. The contractor shall request a completion certificate when all concrete work is completed. The warranty period shall begin on the date of the certificate of substantial completion.

SUPERVISION: The contractor shall have a thoroughly competent supervisor in charge of the work at all times during construction. Anyone deemed incapable to supervise by the City shall be replaced immediately upon request by someone who is satisfactory.

LABOR, MATERIALS & EQUIPMENT: The contractor shall furnish all labor, materials, tools, and other equipment necessary to properly complete the work according to the specifications, as well as any safety devices the contractor deems necessary for safe operations, or as required by law.

INSURANCE: The contractor shall not commence, nor allow a sub-contractor to commence, work under this contract until he has obtained all insurance required under this heading and such insurance has been approved by the owner.

1. Workmen's Compensation Insurance as required by Michigan Workmen's Compensation Laws.
2. Contractor's Public Liability Insurance shall be furnished for \$25,000 limits for injuries to any one person and \$50,000 for any one accident.
3. Contractor's Property Damage Insurance shall be furnished for \$5,000 limits for damages as a result of any one accident and \$10,000 limits as an aggregate.

All policies required shall be written by a company licensed to do business in the State of Michigan. The City shall be named as an additional named insured on all liability policies. A copy of the policy shall be submitted to the City prior to beginning the work.

The Contractor shall notify the City immediately of any damages at the project site, whether or not the contractor is liable.

BONDS: There are no bonds required for this Project.

EQUIPMENT: The Contractor shall furnish all equipment required to perform the work in the attached specifications and any safety devices the contractor feels necessary for safe operations, or as required by law.

SIGNS AND BARRICADES: The City of Greenville will furnish all signs and barricades necessary for the protection of the public and the work, including cones and advance warning signs on the roadways when contractor equipment is in the roadway.

LICENSING & PERMITS: The Contractor shall comply with all local, state and federal regulations and statutes, and shall be licensed to perform work in the State of Michigan.

REFERENCES: All bidders must submit a list of references, which will be a consideration in the award of the contract.

CONTRACT TIME: The Work shall commence in the Spring of 2017 when weather is conducive and materials are available. The target completion for this portion of the Work is May 5, 2017.

PROPOSALS: All bids must be submitted on the attached bid form and received in the Office of the City Clerk at City Hall, 411 S. Lafayette Street, Greenville, Michigan 48838, on or before Tuesday, February 14, 2017 at 2:00 p.m. A bid will be considered complete with the submittal of the three pages (pages 4,5 & 6) of the Bid Proposal, signed and filled out; and a schedule of completion of the work.

BID ENVELOPE LABELING: Please mark "2017 Portage Walkway" on the outside of the envelope and submit to the City Clerk's Office prior to the bid opening.

2017 Greenville Portage Walkway
Instructions to Bidders
Bid Opening: February 14, 2017
Page Three

ADDENDA: If addenda are required on this project, they will be posted to the website at www.greenvillemi.org/bids-rfps/ and distributed to known interested parties no later than 12:00 p.m. (noon) on Monday, February 13, 2017. It is the responsibility of the bidder to check for addenda before the bid and acknowledge any addenda on the bid form.

QUESTIONS: Questions may be directed to Doug Hinken, in the City Engineers office at (616) 754-5645.

RIGHTS RESERVED BY THE OWNER: The City of Greenville reserves the right to accept or reject any or all bids. The competency and responsibility of bidders will be considered in awarding contracts. The Owner does not obligate himself to accept the lowest or any other bid. The Owner reserves the right to waive any informality in any or all bids. The Owner reserves the right to make additions or deletions from the quantity of work to be performed.

BID PROPOSAL

Proposal of _____ (hereinafter called "BIDDER"),
organized and existing under the laws of the State of _____ doing business as *
_____ To the City of Greenville (hereinafter called "OWNER").

In compliance with the Advertisement for Bids, BIDDER hereby proposes to perform all WORK for construction of the **2017 GREENVILLE PORTAGE WALKWAY** in strict accordance with the CONTRACT DOCUMENTS, within the time set forth therein, and at the prices stated below.

By submission of this BID, each BIDDER certifies, and in the case of a joint BID each party thereto certifies as to his own organization, that this BID has been arrived at independently, without consultation, communication, or agreement as to any matter relating to this BID with any other BIDDER or with any competitor.

BIDDER hereby agrees to commence WORK under this contract on or before a date to be specified in the NOTICE TO PROCEED and to have the PROJECT completed by **May 5, 2017** if weather and material availability is conducive.

BIDDER acknowledges receipt of the following ADDENDUM:

The following addenda have been received, are hereby acknowledged, and their execution is included in the above proposal amount:

Addendum No. _____ Dated _____ Addendum No. _____ Dated _____

CERTIFICATION

By submission of this bid, each bidder certifies, and, in the case of a joint bid, each party certifies as to his/her own organization, that this bid has been arrived at independently, without consultation, communication, or agreement as to any matter relating to this bid with any other bidder or with any competitor.

*Insert "a corporation", "a partnership", or "an individual" as applicable.

Further, each bidder also certifies that he/she has examined all sections of the contract documents and the location of the work described herein and is fully informed as to the nature of the work and the conditions relating to its performance.

Bidder understands that the quantities shown are approximate only and are subject to either increase or decrease. Furthermore, the bidder understands that there may be additions or deductions to the items of work. Price adjustments based on added or deleted quantities will be based on the unit prices as stated herein.

The bidder hereby agrees to commence the WORK under this contract within 10 days after the date of the NOTICE TO PROCEED, weather permitting, and to have the project not later than May 5, 2017, unless the period of completion is extended by mutual agreement.

The bidder shall include and shall be deemed to have included, in his/her bid, all Michigan sales and use taxes currently imposed by legislative enactment and as administered by the Michigan Department of Revenue on the bid date.

The bidder agrees to comply with the applicable conditions in the MDEQ Permit included with the Project documents.

The undersigned further agrees to do such extra work as may be authorized, in writing, by the Owner, prices for which are not given in this proposal. Compensation shall be made on the basis agreed upon, in writing, before such work is begun.

The bidder shall base bids on the materials or products specified or shown on the drawings.

All WORK described in the contract documents and required for completion of the project shall be considered to be incidental unless designated as a pay item on the Bid Form. Pay items shall not be used for any components installed for the convenience/or advantage of the contractor regardless of the fact that the type of component is described on the bid sheet.

BID PROPOSAL FORM
2017 GREENVILLE PORTAGE WALKWAY

TO: Office of the City Clerk
 411 S. Lafayette Street
 Greenville, Michigan 48838

	Estimated Quantity	Unit Price	Total Cost
<u>Concrete Work Bid :</u>			
CONCRETE WALKWAY, 4"	455 Sft	\$ _____/Sft	\$ _____
CONCRETE STAIRWAY	1 LS	\$ _____/LS	\$ _____
GROUTING RIP RAP IN PLACE	3.5 Cyd	\$ _____/Cyd	\$ _____
Total Bid			\$ _____

Acknowledgement of Addenda: _____

FIRM NAME: _____ ADDRESS: _____

TELEPHONE: _____

EMAIL: _____

DATED: _____

SIGNATURE: _____

PRINTED NAME: _____

THE CITY RESERVES THE RIGHT TO ACCEPT OR REJECT ANY OR ALL BIDS.

CITY OF GREENVILLE
CONTRACTORS CHECKLIST

I. CERTIFICATION OF INSURANCE

A. WORKERS COMPENSATION

Copy Received_____ Date_____

B. LIABILITY

Copy Received_____ Date_____

1. Limits of Million or More
2. "A" Rated Company

Copy Received_____ Date_____

II. LOSS HISTORY

A. PROVIDED BY AGENT

Copy Received_____ Date_____

III. SAFETY PROGRAM

	Yes	No	N/A
1. Familiar with MIOSHA Regulation	<input type="checkbox"/>	<input type="checkbox"/>	<input type="checkbox"/>
2. Are Safety Standards Used Daily	<input type="checkbox"/>	<input type="checkbox"/>	<input type="checkbox"/>
3. Written Safety Program	<input type="checkbox"/>	<input type="checkbox"/>	<input type="checkbox"/>
4. Safety Coordinator	<input type="checkbox"/>	<input type="checkbox"/>	<input type="checkbox"/>
5. Michigan Right to Know Program	<input type="checkbox"/>	<input type="checkbox"/>	<input type="checkbox"/>
6. Permit Required Confined Space Entry Program	<input type="checkbox"/>	<input type="checkbox"/>	<input type="checkbox"/>
7. Power Lock Out/Tag Out Program	<input type="checkbox"/>	<input type="checkbox"/>	<input type="checkbox"/>
8. First Aid Personnel On Site	<input type="checkbox"/>	<input type="checkbox"/>	<input type="checkbox"/>
9. Emergency Preparedness Plan	<input type="checkbox"/>	<input type="checkbox"/>	<input type="checkbox"/>
10. Fire Safety and Suppression Plan	<input type="checkbox"/>	<input type="checkbox"/>	<input type="checkbox"/>
11. Personal Protective Equipment Used	<input type="checkbox"/>	<input type="checkbox"/>	<input type="checkbox"/>
12. Auto Safety			
a. MVR Checks	<input type="checkbox"/>	<input type="checkbox"/>	<input type="checkbox"/>
b. CDL Certifications	<input type="checkbox"/>	<input type="checkbox"/>	<input type="checkbox"/>
13. Proper MDOT Roadway Procedures	<input type="checkbox"/>	<input type="checkbox"/>	<input type="checkbox"/>
14. Proper Trenching/Excavation Standards			
a. Followed and On-Site	<input type="checkbox"/>	<input type="checkbox"/>	<input type="checkbox"/>
b. Preventive Maintenance Program	<input type="checkbox"/>	<input type="checkbox"/>	<input type="checkbox"/>
15. Process Safety Management of Highly Hazardous Chemicals	<input type="checkbox"/>	<input type="checkbox"/>	<input type="checkbox"/>

I attest that the above responses are true to the best of my knowledge.

Witness:

City Representative

Contractor Representative/ Title

Date

Date

State Contractor License Number

WALKWAY SPECIFICATION

Location and Design

The location of the 2017 Greenville Portage Walkway Project is beneath the Franklin Street Bridge on the south side of the Flat River. This location is near the Flat River Museum, which has an address of 213 N. Franklin Street, Greenville, MI 48838.

The 6-foot wide walkway will run east and west, under the bridge, to provide a smooth walking surface for river-users to safely pass from the upper side of the dam to the lower side. It will be relatively straight and located directly along the bridge abutment wall. No excavation is anticipated in the preparation. It is expected that forms will be set to a consistent grade and cross-slope, as close to existing grade as possible. Sand fill material will be provided to the site by the City of Greenville and placed by the Contractor.

Subgrade Preparation

The Contractor will be responsible for final preparation of the subgrade. The Contractor shall fill and compact the subgrade to 95% of maximum unit density of the in-place soil, prior to pouring of the concrete.

Forms

Forms for the work shall be of lumber, 1½-inches thick. They shall be clean and free from old concrete from previous pours and shall be considered to be permanently left in place. Forms shall be rigidly held to line by stakes or braces. All division plates shall be removed before the pouring of concrete.

Thickness and Proportions

The walkway shall be 4-inches thick. The concrete mix shall meet the requirements of a typical MDOT S2 sidewalk mix, which consists of 526 lbs/cyd of Type 1 Portland Cement and proportions of fine and limestone coarse aggregates and air entraining admixtures to achieve a minimum strength of 3,500 pounds per square inch with a 28 day curing time. It shall have no added chloride. A mix design shall be prepared by the Contractor and submitted for approval prior to any pours. Each load shall be consistent with the approved mix design.

Testing

The City of Greenville reserves the right to test the subgrade density and concrete for air entrainment, slump, temperature and strength. The City of Greenville will bear the costs of such testing, however, the Contractor will pay for failing tests and corrective measures.

Placing and Finishing

Concrete for walkway and stairway shall be placed within 90 minutes after batching. It shall be tamped and struck off with a template and shall be floated with a wood float until the surface has a true contour. Care shall be taken not to bring to the surface an excess of water and fine sand by over-finishing. The final finish shall consist of heavy brooming with a calcimine brush.

Expansion Joints

A 1/2-inch expansion joint of pre-molded strips of bitumen-treated fiber or mineral aggregate shall be installed along the entire bridge abutment wall.

Jointing and Edging

Joints shall be cut every 6-feet of sidewalk and both edges of walk edged. The edges and joints for the walkway shall be rounded to a 1/4-inch radius.

Curing

After initial set of the concrete and within 24 hours, all new exposed concrete surfaces shall be sprayed with white membrane curing compound. Extreme care shall be taken to avoid overspray onto adjacent surfaces. The Contractor shall be responsible for cleanup of any over-sprayed membrane material.

Form Removal and Clean-up

After the forms along the free edge have been removed, the Contractor shall place suitable material along the edge of the sidewalk and up to the top of the walk to protect the edge.

Protection of the Work

The Contractor shall be responsible to protect the work to the degree necessary to prevent damage by the public either unintentionally or intentionally. The Contractor should plan his work in such a way that he can watch newly poured concrete until the point that the surface is sufficiently hard to prevent damage by those intending to mar new concrete. Any work found with marred surfaces shall be immediately repaired; if possible, otherwise the marred sections of walk shall be removed and replaced at the Contractor's expense.

Measurement & Payment:

Concrete Walkway, 4": Concrete Walkway, 4" will be paid for at the Contract Unit Price as shown in the bid proposal for all standard concrete surfaces as measured as a rectangular shape. The work being paid for in this item includes all material, equipment and labor to prepare the subgrade; set forms; pour new concrete to the width and grades as given by the Engineer; protection of the public, workers and the work; curing compound; cleanup and anything else necessary to complete the work.

STAIRWAY SPECIFICATION

Location and Design

The location of the 2017 Greenville Portage Walkway Project is beneath the Franklin Street Bridge on the south side of the Flat River. This location is near the Flat River Museum, which has an address of 213 N. Franklin Street, Greenville, MI 48838.

The 6-foot wide walkway will run east and west, under the bridge. There is a sharp grade change near the west side of the bridge abutment that will require a stairway. It is anticipated that the stairway will require 3, 8-inch high risers and 3, 18-inch deep treadways. There is some excavation required to anchor the toe of the stairway in place. Sand fill material will be provided to the site by the City of Greenville and placed by the Contractor.

Subgrade Preparation

The Contractor will be responsible for final preparation of the subgrade. The Contractor shall fill and compact the subgrade to 95% of maximum unit density of the in-place soil, prior to pouring of the concrete.

Forms

Forms for the construction of the stairway shall be clean and free from old concrete from previous pours and shall be considered to be permanently left in place. Forms shall be rigidly held to line by stakes or braces. All division plates shall be removed before the pouring of concrete. Stairway forms shall be sufficiently thick to maintain a uniform width and thickness through the entire pour.

Concrete Mix

The concrete mix shall meet the requirements of a typical MDOT S2 sidewalk mix, which consists of 526 lbs/cyd of Type 1 Portland Cement and proportions of fine and limestone coarse aggregates and air entraining admixtures to achieve a minimum strength of 3,500 pounds per square inch with a 28 day curing time. It shall have no added chloride. A mix design shall be prepared by the Contractor and submitted for approval prior to any pours. Each load shall be consistent with the approved mix design.

Stairways shall be formed to the standard plans provided. Steel reinforcement shall be epoxy coated except the welded wire fabric. In no case shall any steel be located closer than 3 inches from any outside surface.

Testing

The City of Greenville reserves the right to test the subgrade density and concrete for air entrainment, slump, temperature and strength. The City of Greenville will bear the costs of such testing, however, the Contractor will pay for failing tests and corrective measures.

Placing and Finishing

Concrete for walkway and stairway shall be placed within 90 minutes after batching. It shall be tamped and struck off with a template and shall be floated with a wood float until the surface has a true contour. Care shall be taken not to bring to the surface an excess of water and fine sand by over-finishing. The final finish shall consist of heavy brooming with a calcimine brush.

Expansion Joints

A ½-inch expansion joint of pre-molded strips of bitumen-treated fiber or mineral aggregate shall be installed along the bridge abutment wall.

Jointing and Edging

The edges of the stairway shall be rounded to a 1/4-inch radius.

Curing

After initial set of the concrete and within 24 hours, all new exposed concrete surfaces shall be sprayed with white membrane curing compound. Extreme care shall be taken to avoid overspray onto adjacent surfaces. The Contractor shall be responsible for cleanup of any over-sprayed membrane material.

Form Removal and Clean-up

The forms may be removed if possible to do so without disturbing the adjacent rip rap.

Protection of the Work

The Contractor shall be responsible to protect the work to the degree necessary to prevent damage by the public either unintentionally or intentionally. The Contractor should plan his work in such a way that he can watch newly poured concrete until the point that the surface is sufficiently hard to prevent damage by those intending to mar new concrete. Any work found with marred surfaces shall be immediately repaired; if possible, otherwise the marred sections of walk shall be removed and replaced at the Contractor's expense.

Measurement & Payment:

Concrete Stairway: The Concrete Stairway will be paid for as a complete unit at the Contract Unit Price as shown in the bid proposal. The work being paid for in this item includes all material, equipment and labor to prepare the subgrade, set all necessary forms; reinforce; construct the stairway according to the plan; backfill with granular material; grade to match existing ground, and anything else necessary to construct the stairway according to the plan with approximate quantities of 1.8 cubic yards of concrete; 16½ feet of epoxy-coated #4 steel reinforcing bar; and 27 square feet of 6"x 6" steel welded wire fabric.

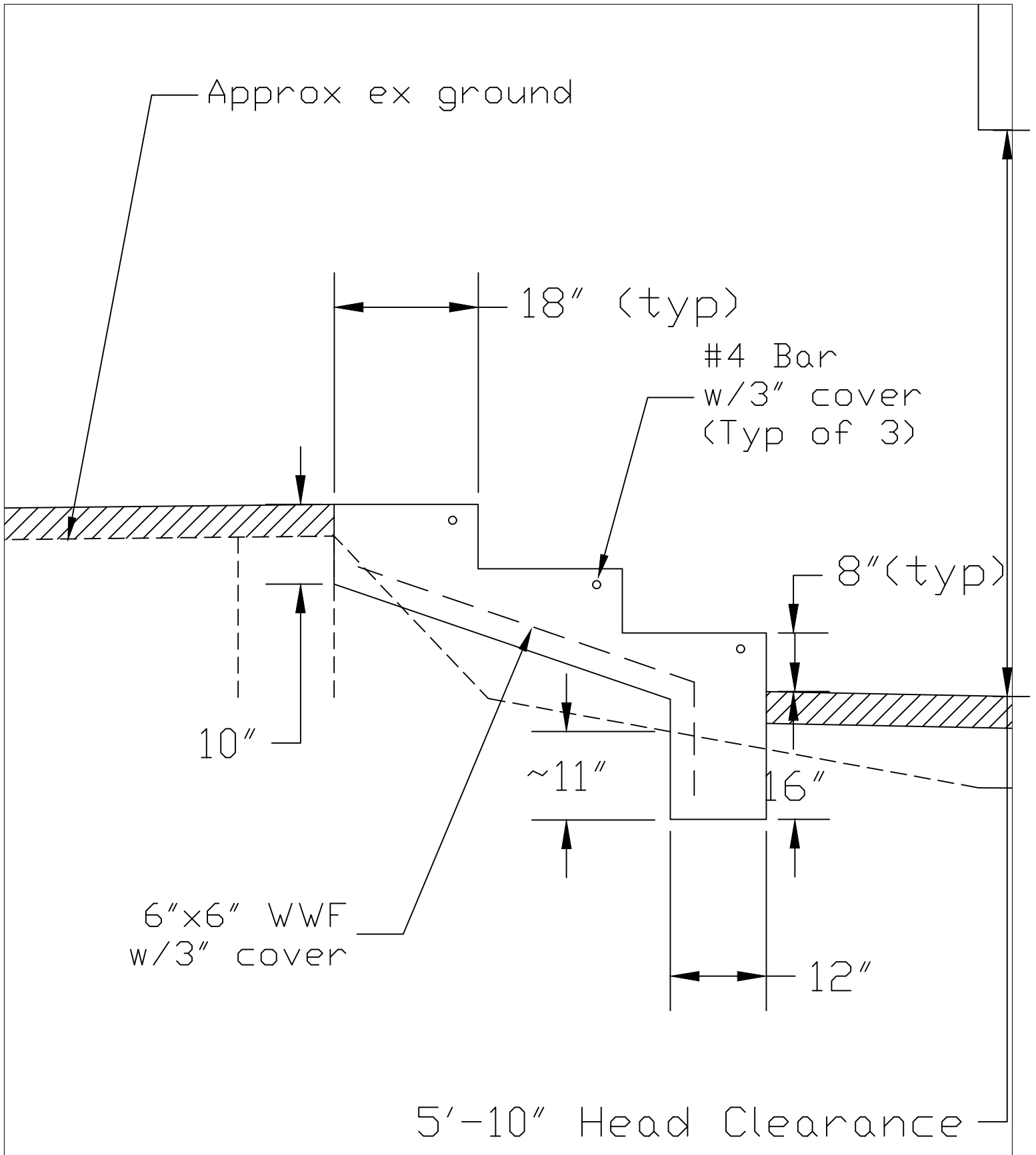

2017 PORTAGE WALKWAY - STAIR DETAIL



CITY OF GREENVILLE
ENGINEERING DEPARTMENT
 411 S. LAFAYETTE, GREENVILLE, MI 48838
 TELEPHONE (616) 754-5645

HORIZONTAL SCALE: None

VERTICAL SCALE:

FILE: DAM

JOB #: 401-751.000-974.501

DRAWN BY: dwh

DATE: 12/16/16

REVISED:

SHEET 1 OF 1

GROUTING RIPRAP IN-PLACE SPECIFICATION

Location and Design

The location of the 2017 Greenville Portage Walkway Project is beneath the Franklin Street Bridge on the south side of the Flat River. This location is near the Flat River Museum, which has an address of 213 N. Franklin Street, Greenville, MI 48838.

The City of Greenville Public Services Department will furnish and place rip rap in the area between the proposed sidewalk and the abutment wall for the dam except in an area as directed by the Contractor to allow for form setting. The Contractor shall move the riprap into place along the edge of the form as necessary.

The natural stone riprap will be of a size that can be moved. An unintended consequence of the sizing is that the stones are often thrown into the River. Therefore, it is the City's intention that the riprap placement be made permanent by use of grout material to be placed by the Contractor.

Sufficient grout should be used to fill in the voids between stones and cover the top layer of stone so that a maximum of $\frac{1}{4}$ of the stone diameter is exposed. The beauty of the natural stone is intended to be on display so the Contractor will need to immediately remove excess grout with a stiff brush.

Grout Mix

The grout mix shall meet the requirements of a typical MDOT Type R-3 Mortar mix, which consists of 765 lbs/cyd of Type I, or IA Portland Cement; 2,266 lbs/cyd of 2NS fine aggregate and 353 lbs/cyd of net water. A mix design shall be prepared by the Contractor and submitted for approval prior to any pours. Each load shall be consistent with the approved mix design.

Placing and Finishing

Sufficient grout should be used to fill in the voids between stones and cover the top layer of stone so that a maximum of $\frac{1}{4}$ of the stone diameter is exposed. The beauty of the natural stone is intended to be on display so the Contractor will need to immediately remove excess grout with a stiff brush.

Measurement & Payment:

Grouting Riprap In-Place: Grouting Riprap In-Place will be paid by the cubic yard at the Contract Unit Price as shown in the bid proposal. The load ticket from the material Supplier will be the basis of measurement and payment. The work being paid for in this item includes all material, equipment and labor to pump and place the grout, along with cleaning the stone surface, and cleaning up after the placement is complete.

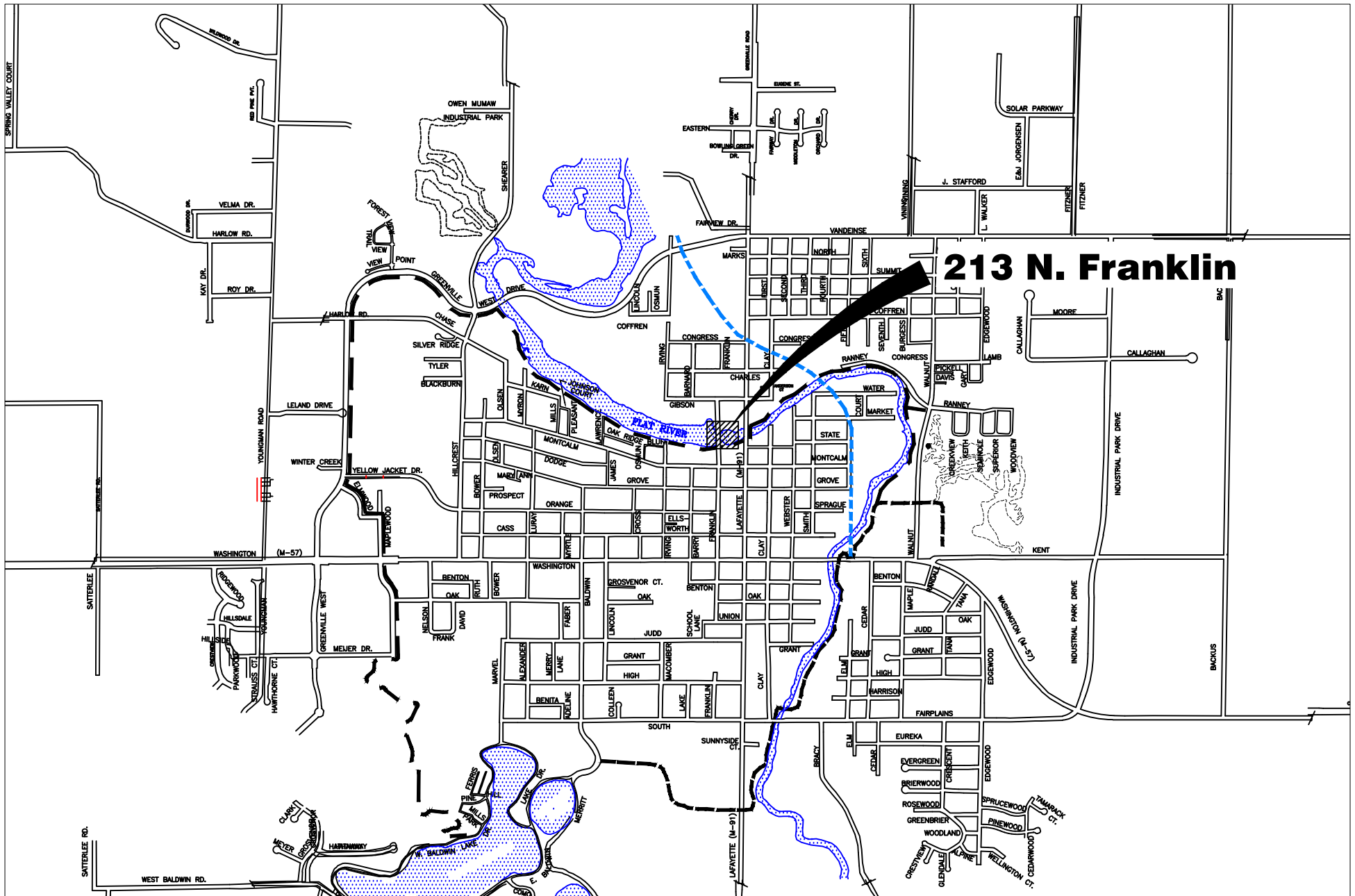

FRANKLIN STREET DAM PORTAGE – LOCATION MAP

CITY OF GREENVILLE

ENGINEERING DEPARTMENT

411 S. LAFAYETTE, GREENVILLE, MI 48838
 TELEPHONE (616) 754-5645

HORIZONTAL SCALE: None

VERTICAL SCALE: None

FILE: City.dwg

JOB #:

DRAWN BY: dwh

DATE: 12/12/16

REVISED:

SHEET 1 OF 1

